

room	dimension	ceiling height	sq. ft.	theater style	classroom style	conference style	reception style	banquet style
<b>MEZZANINE LEVEL</b>								
Mezzanine 1	31' x 14'	10'	413	40	21	20	30	30
Mezzanine 2	31' x 28'	10'	733	50	35	25	40	40
Mezzanine 3	31' x 29'	10'	656	50	35	25	40	40
Executive Boardroom	31' x 14'	10'	420	0	0	12	0	0
<b>16th FLOOR</b>								
GALAXY BALLROOM	73' x 60'	14'	3,446	300	200	96	350	240
STARS	55' x 18'	16'	990	50		30	150	60
Stars 1	27' x 9'	16'	495	20		10	60	20
Stars 2	7' x 9'	16'	495	20		10	60	20

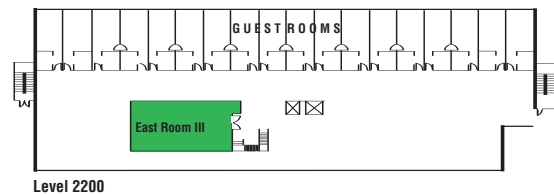
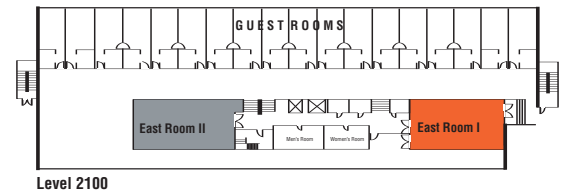
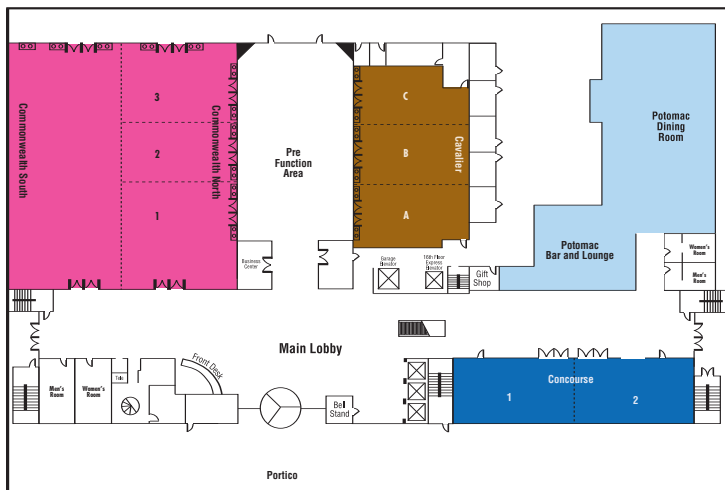

room	dimension	ceiling height	sq. ft.	theater style	classroom style	conference style	reception style	banquet style
<b>COMMONWEALTH BALLROOM</b>								
Commonwealth Ballroom	94' x 102'	16'	9,082	1,000	470	0	900	600
North	45' x 101'	16'	4,523	400	200	128	400	300
North 1	45' x 36'	16'	1,507	100	80	64	100	80
North 2	45' x 30'	16'	1,312	100	80	56	80	80
North 3	45' x 35'	16'	1,504	100	80	64	120	80
South	49' x 102'	16'	4,759	500	300	128	420	320
Assembly	104' x 42'	9'	3,427	0	0	0	300	0
<b>CAVALIER</b>								
Cavalier	37' x 73'	9'	2,467	200	120	88	200	180
Cavalier A	37' x 24'	9'	821	50	40	25	75	50
Cavalier B	37' x 24'	9'	841	50	40	25	75	50
Cavalier C	37' x 24'	9'	805	50	40	25	75	50
<b>CONCOURSE</b>								
Concourse	27' x 85'	9'	2,100	200	100	80	200	150
Concourse 1	27' x 42'	9'	1,041	85	70	40	100	80
Concourse 2	27' x 43'	9'	1,059	85	70	40	100	70
<b>EAST BUILDING</b>								
East 1	45' x 22'	10'	923	60	40	35	50	60
East 2	44' x 22'	10'	913	60	40	30	50	60
East 3	37' x 21'	7'	743	40	30	20	40	50